



**Model 22HHP-10
(Bushingsmount)**



**Model 22HHP-10
(Servomount)**

● Standard Dimensions

■ Bushingsmount type

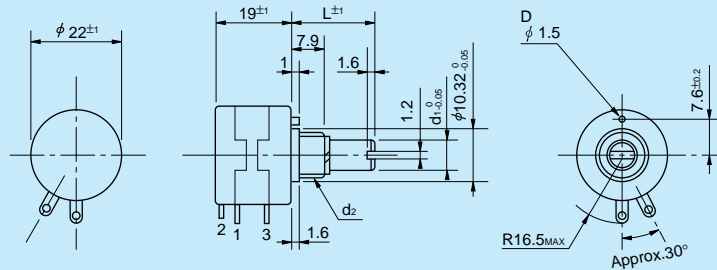

Note: Dimensions of shaft and bushing are equal to those of model 22HP series with wirewound resistive element and please refer to those dimensions and notes.

■ Servomount type (bronze bearing incorporated)

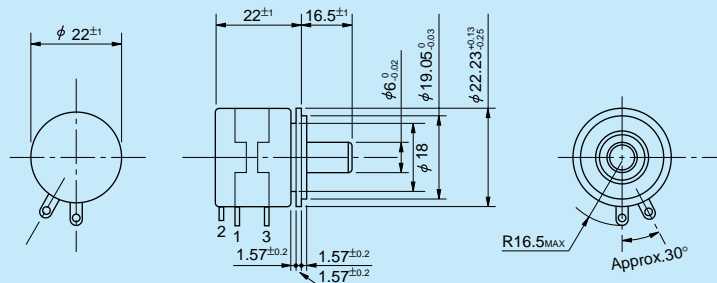

● Standard Model Nos.

Bushingsmount type:

5-turn models:	22HHP-5	22HHP-5M
	22HHP-5E	22HHP-5N
10-turn models:	22HHP-10	22HHP-10M
	22HHP-10E	22HHP-10N

Servomount type:

5-turn models:	22HHP-5
10-turn models:	22HHP-10

● General Specifications

Standard Resistance Values:

1k,2k,5k,10k,20k,50k (Ω) (5-turn)
2k,5k,10k,20k,50k,100k (Ω)(10-turn)

Total Resistance Tolerance:

Standard Class $\pm 10\%$ (K)
Precision Class $\pm 5\%$ (J)

Independent Linearity Tolerance:

	5-turn	10-turn
Standard Class	$\pm 0.35\%$	$\pm 0.25\%$
Precision Class	$\pm 0.2\%$	$\pm 0.1\%$

Resolution:

Essentially infinite

Output Smoothness:

Below 0.05% against input voltage (5-turn)
Below 0.015% against input voltage (10-turn)

Contact Resistance Variation:

Below 5% C.R.V. (5-turn)
Below 3% C.R.V. (10-turn)

Power Rating:

1.0W (5-turn)
2.0W (10-turn)

Electrical Travel:

$360^{\circ} \times n \pm 5^{\circ}$ (n: No. of turns)

Mechanical Travel:

$360^{\circ} \times n + 10^{\circ}$ (n: No. of turns)

Insulation Resistance:

Over 100M Ω at 1,000V.D.C.

Dielectric Strength:

1 minute at 1,000V.A.C.

Starting Torque:

Below 5mN \cdot m (50gf \cdot cm)

Stopper Strength:

Approx. 0.9N \cdot m (9kgf \cdot cm)

Max. Working Voltage:

500V

Resistance Temperature Coefficient:

± 100 p.p.m./ $^{\circ}$ C

Max. Torque exerted on fastening the mounting nut to the bushing:

Below 1.0N \cdot m (10kgf \cdot cm)
(In case of panel thickness with over 2.5mm., the rotating torque may become heavier.)

Mass:

Approx. 20g (Bushingsmount)
Approx. 30g (Servomount)
(Both 5-turn and 10-turn)

● Special Specifications Available

Shaft with front and rear extension (Rear shaft with 6mm dia. and 15mm length), 3-turn type, Multi-ganged (Available up to 10 gangs), With high torque, Special shaft dia. ($\phi 3$ mm, $\phi 3.175$ mm, $\phi 4$ mm, $\phi 5$ mm, $\phi 6.35$ mm), Special machining on the shaft, With plastic shaft, Metal bushing type (22HHPM with anti-rotation pin), Simple sealed housing, Extra taps (Available up to 1 tap only for 10-turn), Slipping-clutch incorporated type.