



- Compact for High Density PCB Mount
- DC Control, AC Output
- Cost Effective Solution
- High Switching Speed
- Low Control Power

The CR series are directly compatible with the industry standard 6.2mm relay interface modules, offering a high reliability solid state switching solution for application where mechanical relays have a limited lifetime.

Crydom solid state products offer optimum performance and quality.

CURRENT DERATING CURVES

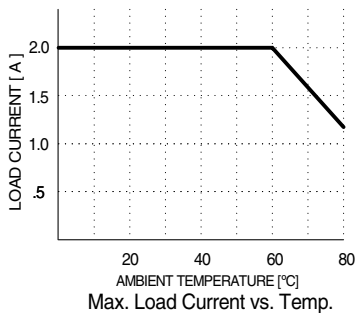

MECHANICAL OUTLINE

Dimensions

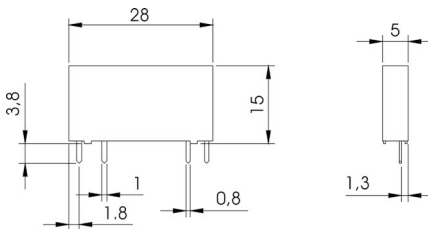

Mounting hole Layout

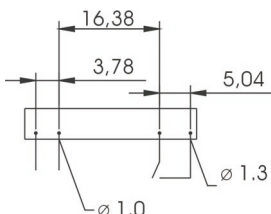

Note: Dimensions in [mm]

MODEL NO.

CR01A-2240

CR02A-2240

INPUT SPECIFICATIONS

Nominal Control Voltage	24 Vdc	60 Vdc
Control Voltage Range	15-30 Vdc	35-72 Vdc
Nominal Input Impedance	3.2 KOhm	21.3 KOhm
Typical Input Current @ Nominal Voltage	7 mA	3 mA
Must Turn On Voltage	15 Vdc	35 Vdc
Must Turn Off Voltage	9 Vdc	35 Vdc

OUTPUT SPECIFICATIONS

Operating Voltage Range (47-63 Hz)	12-280 Vrms
Load Current Range	.025 - 2Arms
Transient Over-Voltage	600 Vpk
Max. Surge Current, (20ms)	40 Apk
Maximum I ² t for fusing (10ms)	8 A ² s
Min. Off-State dv/dt @ Max. Rated Voltage ^③	500 V/μsec
Max. Off-State Leakage @ Rated Voltage	1.5 mArms
Max. On-State Voltage Drop @ Rated Current	1.6 Vpk
Max. Turn-On Time	1/2 cycle
Max. Turn-Off Time	1/2 cycle

GENERAL SPECIFICATIONS

Dielectric Strength	2500 Vrms
Ambient Operating Temperature Range	-20 to 80 °C
Ambient Storage Temperature Range	-40 to 100 °C

© 2004 CRYDOM CORP, Specifications subject to change without notice.

GENERAL NOTES

- ① All parameters at 25° C unless otherwise specified.
- ② Dielectric strength and insulation resistance measured between input and output.
- ③ Off-State dv/dt test method per EIA/NARM standard RS-443.

For recommended applications and more information contact:

USA: Sales Support (877) 502-5500 **Tech Support** (877) 702-7700 **FAX** (619) 710-8540

Crydom Corp, 2320 Paseo de las Americas, Ste. 201, San Diego, CA 92154

Email: sales@crydom.com **WEB SITE:** <http://www.crydom.com>

UK: +44 (0)1202 365070 • **FAX** +44 (0)1202 365090 Crydom International Ltd., 7 Cobham

Road, Ferndown Industrial Estate, Ferndown, Dorset BH21 7PE, **Email:** intsales@crydom.com.

GERMANY: +49 (0)180 3000 506

