

# JIN ZON ENTERPRISE CO., LTD.

4F-3, No. 171, Sec. 2, Chang An E. Rd.,  
 Taipei, Taiwan, R. O. C.  
 TEL: 886-2-27111093~5  
 FAX: 886-2-27310902  
 E-mail: [jinzon@ms2.hinet.net](mailto:jinzon@ms2.hinet.net)  
 Http:// [www.jinzon.com.tw/](http://www.jinzon.com.tw/)

## Reed sensor MS for PCB

This product is in accordance with RoHs

These sensors are designed for PCB mounting.

Sensors are operated by permanent magnets size and parameters of which depend on user's applications. Sensitivities of switches are indicated below expressed as ampere turns measured in standard coil.  
 In case of doubts please contact the producer.

**MS01**

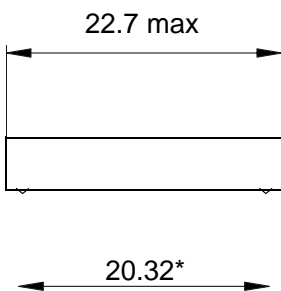

**MS02**

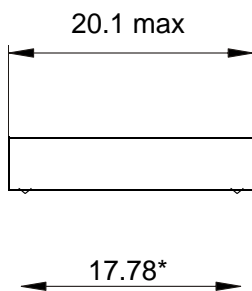

**MS03**

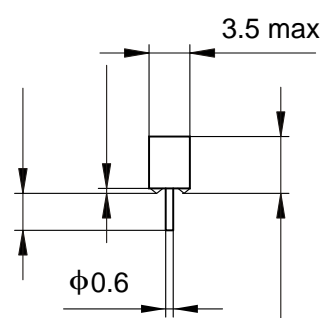
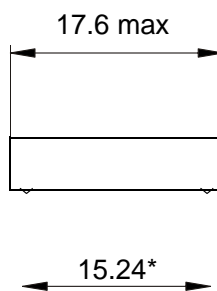

all dimensions in mm

\* dimension for tool

DATA SCAN	Unit	TYPE			
		MS01-01 MS02-01 MS03-01	MS01-02 MS02-02 MS03-02	MS01-03 MS02-03 MS03-03	MS01-04 MS02-04 MS03-04
Contact form		normally open			
Pull-in Ampere turns	AT	9 ÷ 12	10 ÷ 15	15 ÷ 20	20 ÷ 25
Switching power	max W	10		10	
Switching voltage	max V <sub>DC</sub>	50		100	
Switching current	max A	0.5		0.5	
Carry current	min A	1		1	
Contact resistance	max mΩ	100		100	
Breakdown voltage	min V <sub>DC</sub>	100		200	
Operate time incl. bounce time	max ms	1.		1	
Release time	max ms	0,1		0,1	
Environment category acc. to IEC 68-1		40/85/21			

Typical applications :  
 micro switch, garage doors, elevators, washing machines.